



BRIGHTON HOUSE

52

53-54 Regency Square

Brighton, BN1 2FF

£275,000



# 53-54 Regency Square

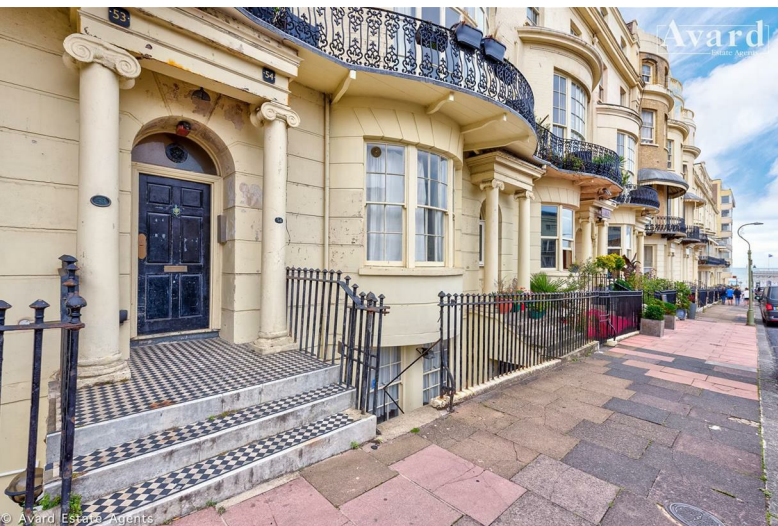

## Description

Avarde estate agents are delighted to offer for sale this 1 bedroom flat located in the heart of Brighton with the benefit of a share of the freehold and having fully refurbished to a very high standard by current vendor. Accommodation comprises of stairs to third floor, entrance lobby, hallway, living/dining area with views of the square to the sea, modern kitchen, double bedroom and modern bathroom.

Fantastic views await the new owner of this rather grand & spacious apartment in one of Brighton's most prestigious seafront squares. Home to the iconic Brighton i360, this is an exciting opportunity for someone to secure their dream home with the most exciting piece of architecture on their doorstep since the Regency period.

Regency Square has so much to offer, a central location just moments from the high street, the Churchill Mall, theatres, bars and restaurants, yet when in the square itself you could be a million miles away and transported back to the wonderful Regency period.

- 581 Square Feet
- Sea Views
- Sea Front Location
- Ideal Holiday Home
- No Onward Chain
- Share Of Freehold
- Must Be Viewed
- Excellent Order





© Avard Estate Agents



© Avard Estate Agents

## Floor Plan

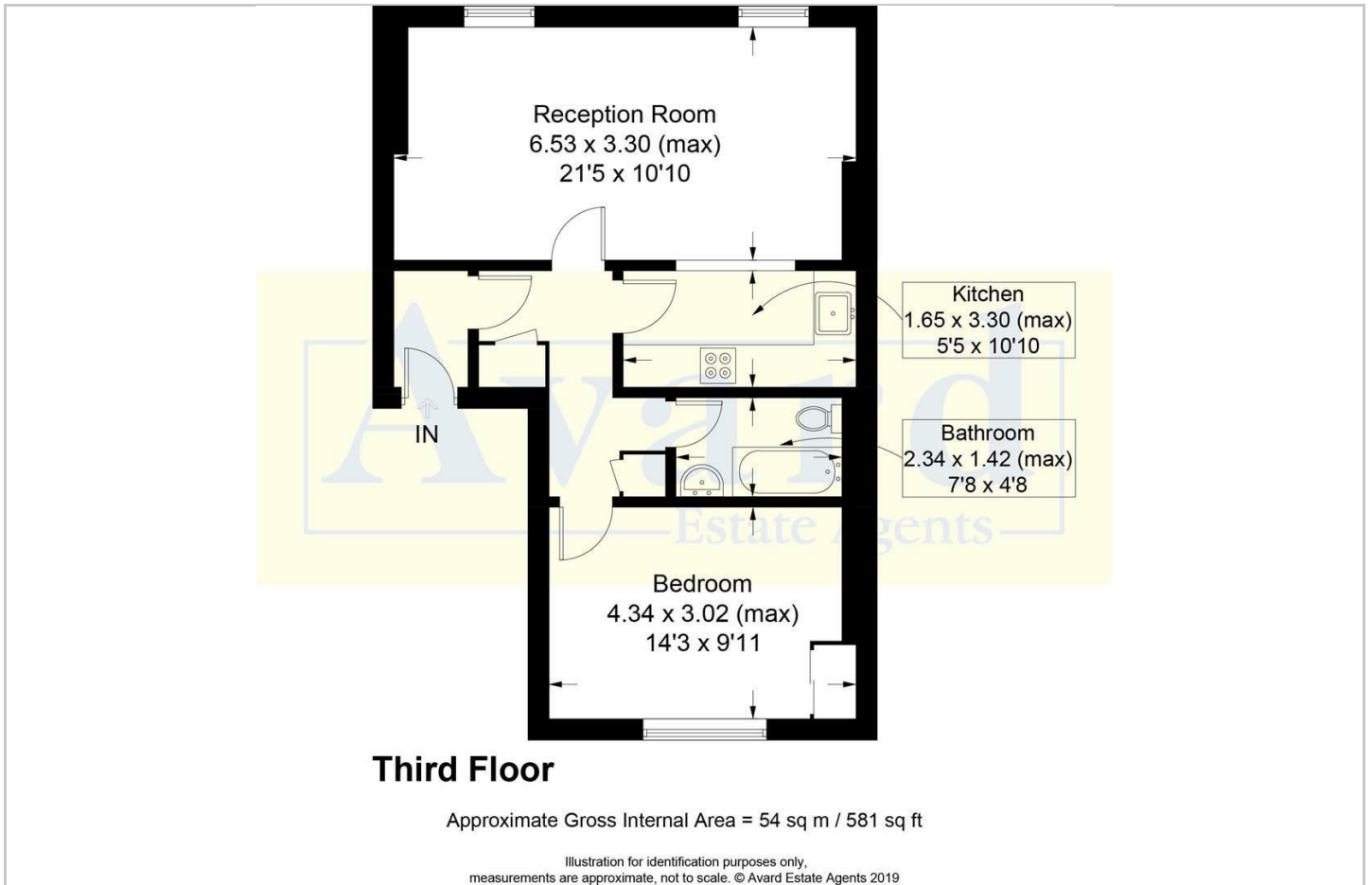

## Area Map



## Viewing

Please contact our Avard Estate Agents Office on 01273696000 if you wish to arrange a viewing appointment for this property or require further information.

## Energy Efficiency Graph

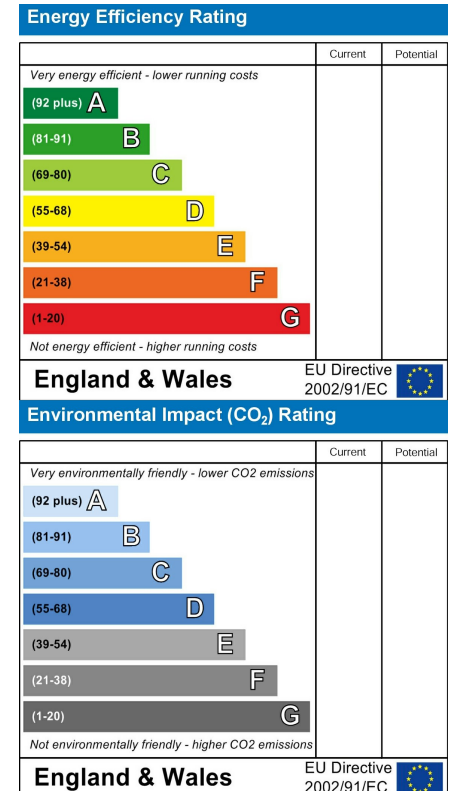

These particulars, whilst believed to be accurate are set out as a general outline only for guidance and do not constitute any part of an offer or contract. Intending purchasers should not rely on them as statements of representation of fact, but must satisfy themselves by inspection or otherwise as to their accuracy. No person in this firm's employment has the authority to make or give any representation or warranty in respect of the property.